

I-90, US-95 IC PROJECT: NORTHWEST BLVD, I-90 TO APPLEWAY AVE

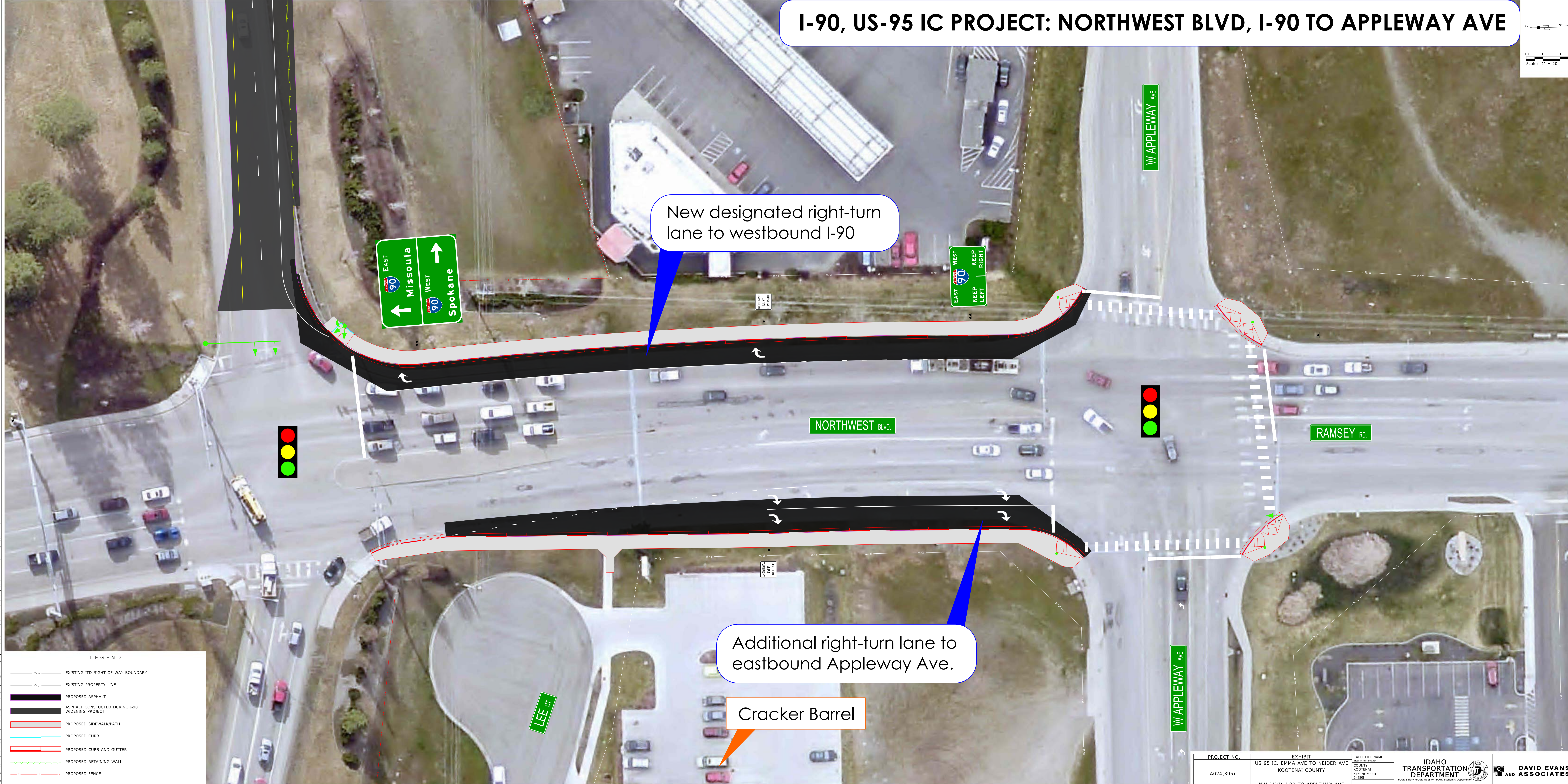
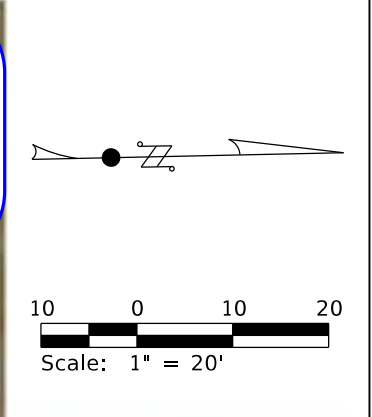

New designated right-turn lane to westbound I-90

Additional right-turn lane to eastbound Appleway Ave.

Cracker Barrel

LEGEND

- EXISTING ITD RIGHT OF WAY BOUNDARY
- EXISTING PROPERTY LINE
- PROPOSED ASPHALT
- ASPHALT CONSTRUCTED DURING I-90 WIDENING PROJECT
- PROPOSED SIDEWALK/PATH
- PROPOSED CURB
- PROPOSED CURB AND GUTTER
- PROPOSED RETAINING WALL
- PROPOSED FENCE

PROJECT NO. A024(395)	EXHIBIT US 95 IC, EMMA AVE TO NEIDER AVE KOOTENAI COUNTY NW BLVD, I-90 TO APPLEWAY AVE	CADD FILE NAME DATE: 04/10/2024 COUNTY KOOTENAI KEY NUMBER 24395 SHEET 4 OF 5	 IDAHO TRANSPORTATION DEPARTMENT DAVID EVANS AND ASSOCIATES INC.
--------------------------	---	---	---

2/28/2025 2:28:05 PM \\fs01\share\hwy\ic\p\p\01\Documents\Public\IC_95\IC95\Process_Development\Public_Review\0424395_11_1124_005